

rectangular  
eco mode   
ficha técnica  
datasheet

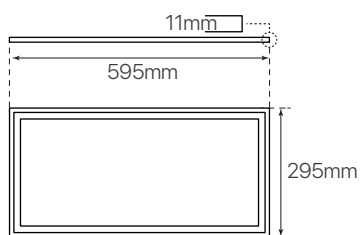

ref. 5551630

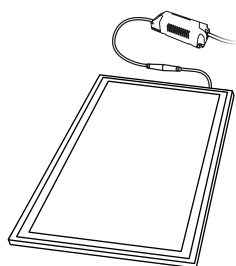
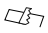

 585mm x 285mm

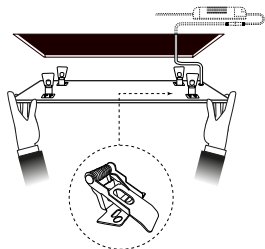

opcional **x4**

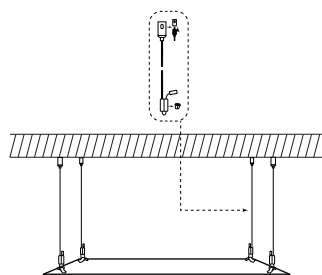

Nombre / Name	Rectangular eco mode  • panel led
Referencia / Reference	5551630
Materiales / Materials	Aluminio + PMMA / Aluminum + PMMA
Difusor / Diffuser	PMMA
Potencia / Power	24W
Temperatura de color / Color temperature	4200K
Flujo luminoso / Luminous flux	1900lm
Dimable / Dimmable	Opcional, consultar / Consult us
Ángulo de apertura / Beam angle	120°
Ángulo de detección / Detection angle	-
IP	40
IK	07
F.P	>0,9
UGR	≤19
IRC	>80
Chip	EPISTAR 4014
Driver	i-TEC series
Vida media (duración) / Average life	+30,000h
Clase energética / Energy class	A+
Aislamiento eléctrico / Electrical isolation	Clase I / Class I
Colores / Colors	Blanco / White
Medida exterior / Product size	295mm x 595mm x 10mm
Medidas de corte / Cutting measurements	285mm x 585mm
Tª (ambiente/trabajo) / Tª (entornament/work)	-10°C ~ 75°C
Input	AC110 ~ 249V
Output	DC60 ~ 80V 300mA ±5%
Frecuencia / Frequency	50 / 60Hz
Peso / Weight	1,5kg
Certificados / Certificates	CE RoHS
Garantía / Warranty	2 años / 2 years